

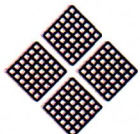

CRYSTAL RIDGE

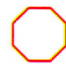

HEATH & ASSOCIATES, INC
 Transportation and Civil Engineering

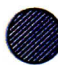

-  EXISTING STOP SIGN
-  PROPOSED SPEED TABLE
-  PROPOSED SPEED CUSHION
-  PROPOSED TRAFFIC CIRCLE

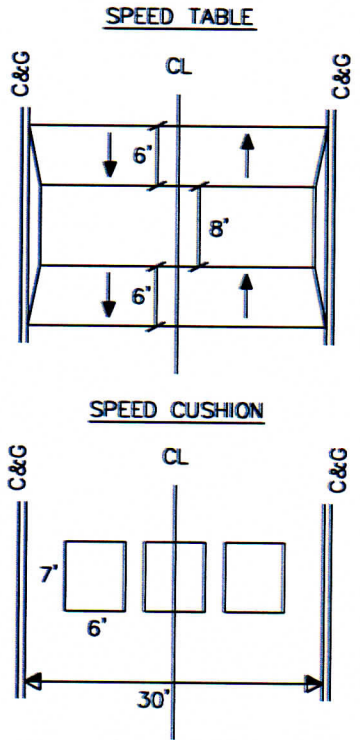

TRAFFIC CALMING PLAN
FIGURE 1/1

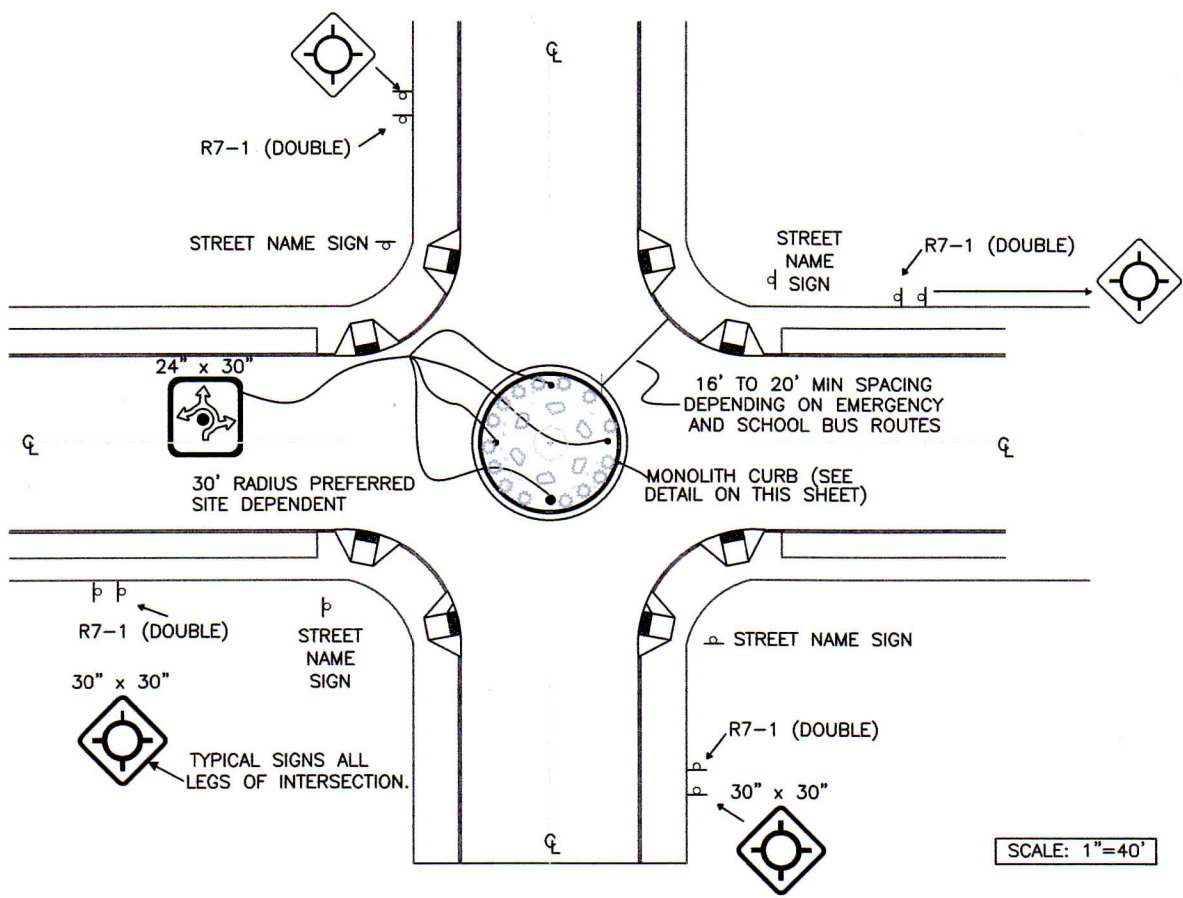

SCALE: 1"=40'

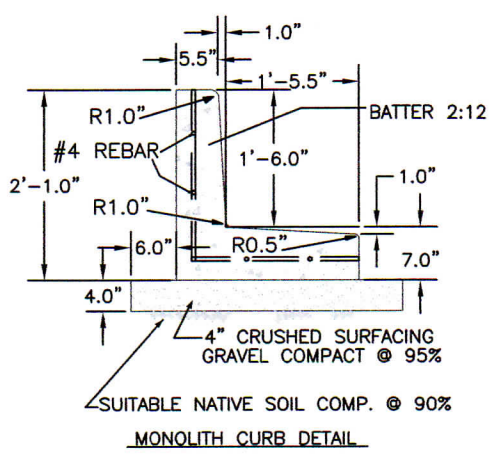

SCALE: 1"=2"

LEGEND	
	TREES SEE CITY STREET TREE ORDINANCE FOR TYPE.
	SHRUBS FOUNTAIN GRASS, FROSTY CRUEL, MOLINA, CAREX FLAGELIFERA, BLUE GRASS, LAVANDULA,
	GROUND COVER KINNIKINNICK, COTONEASTER EVERGREEN LOW GROWTH
	BULBS DAFFODIL, TULIPS AND CROCUS OTHER PLANT MATERIAL BY APPROVAL



CITY OF PUYALLUP

DEVELOPMENT ENGINEERING and PUBLIC WORKS DEPARTMENTS

TRAFFIC CIRCLE

DRAWN BY JIM ERWIN-SVOBODA	CHECKED BY LINDA LIAN	APPROVED BY COLLEEN HARRIS	REVISED BY LINDA LIAN	CITY STANDARD
FILE NAME F:\DWG\COMMON\STDS\CITY\2009\01_STR\01.03\01.03.01	DATE APPROVED 07/01/2009	DATE REVISED 03/21/11	SCALE VARIES	01.03.01

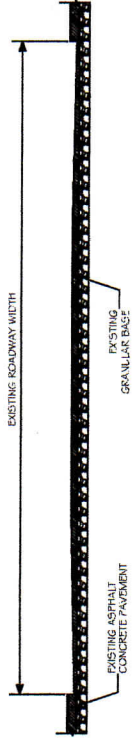
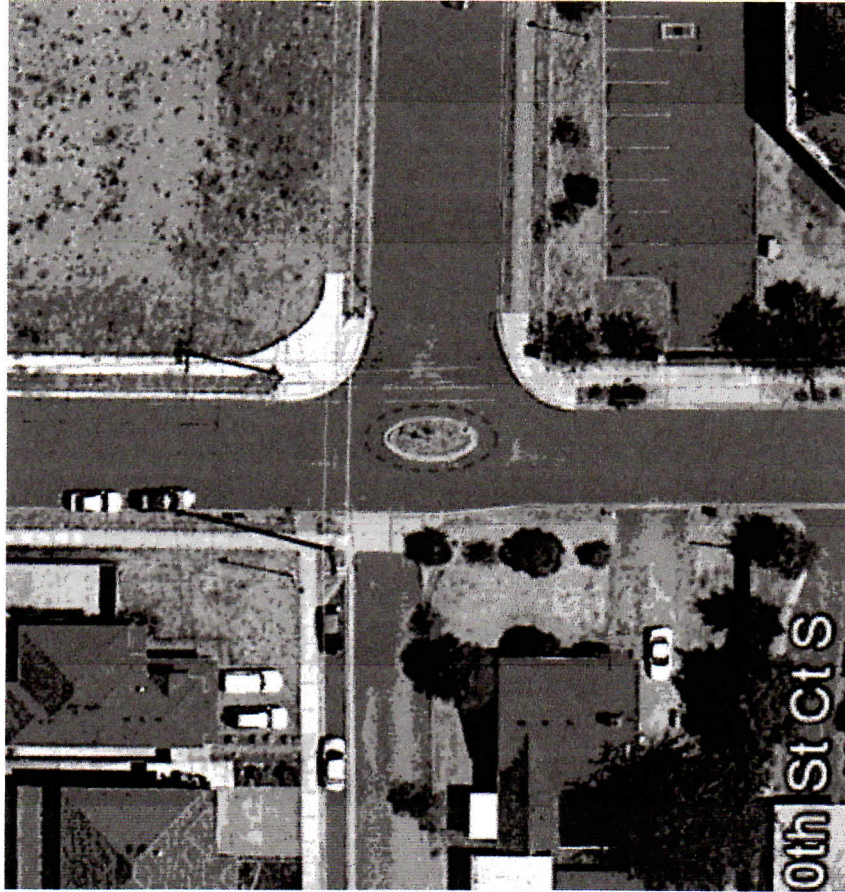

MATCH EXISTING PAVEMENT PROFILE

GENERAL NOTES:

- 1 MATERIALS AND CONSTRUCTION REQUIREMENTS SHALL BE PER LATEST EDITION OF WSDOT STANDARD SPECIFICATIONS FOR ROAD, BRIDGE, AND MUNICIPAL CONSTRUCTION UNLESS OTHERWISE NOTED.
- 2 EXACT LOCATION OF ROUND ABOUT CUT TO BE DETERMINED BY THE PROJECT ENGINEER.
- 3 MONUMENTS WITHIN REMOVAL AREA OF ROUND ABOUT WILL BE RELOCATED.

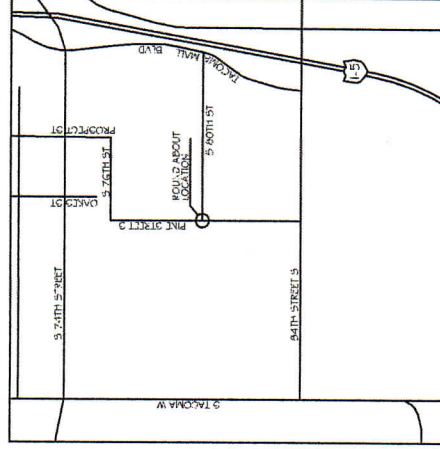

PACIFIC SPORT CENTER



ROUND ABOUT REMOVAL
FIGURE 3/3

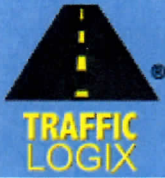

MENU

- ABOUT
- PRODUCTS & SOLUTIONS
- MUNICIPALITIES & ENGINEERS
- RESIDENTS
- TRAFFIC CALMING
- MEDIA
- RESOURCES

>Products and Solutions

Radar Speed Signs

- > [SafePace 100](#)
- > [SafePace 400](#)
- > [SafePace 500](#)
- > [SafePace 600](#)
- > [Radar Speed Sign Trailer](#)
- > [School Zone System](#)

Modular Rubber Solutions

- > [Speed Humps](#)
- > [Speed Tables](#)
- > [Speed Cushions](#)
- > [Traffic Circles](#)
- > [Curb Extensions/Medians](#)
- > [Alley Bumps](#)
- > [Cycle Lane](#)
- > [Mini Humps](#)
- > [Car Stops](#)

[Municipal Solutions](#) << [Speed Tables](#)

Speed Tables

Speed tables are flat-topped speed humps and are generally long enough for the entire wheelbase of a passenger car to rest on top. The design of speed tables allows for more gradual slowing of vehicle speed than humps. This makes speed tables the ideal solution for roads with typical residential speed limits.



- Main
- Features
- Dimensions**
- Technical Specs
- Installation Guide
- Photos

Dimensions

14' Speed Table Specs

Dimensions:
14' length x 3" high x road width
(adjustable in 1.5' increments)
Dimensions shown below 14' x 3" x 22.5'

21' Speed Table Specs

Dimensions:
21' length x 3" high x road width
(adjustable in 1.5' increments)
Dimensions shown below 7' x 3" x 22.5'

Product Warranty

Conditional Use Terms

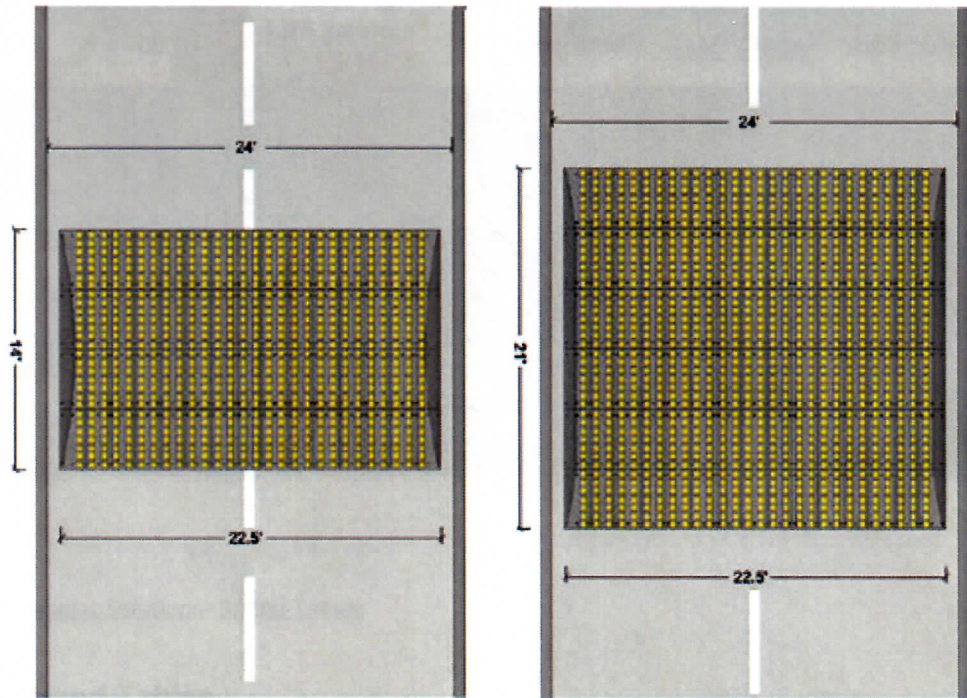

While standard product sizes are shown, the interlocking devices are fully customizable to any length or road width.

Traffic Logix solutions have been installed in hundreds of locations across North America.

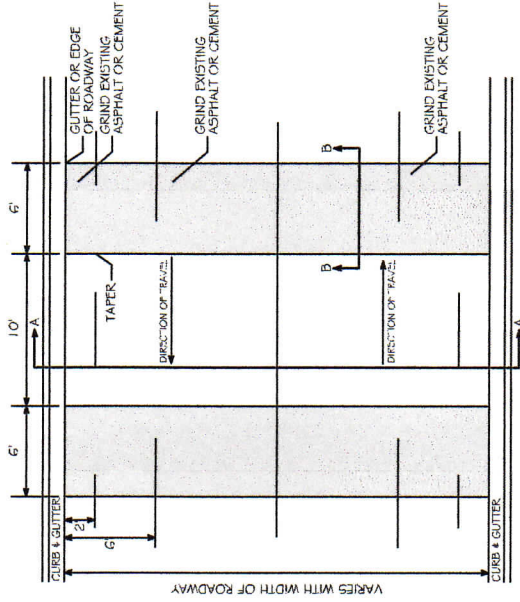
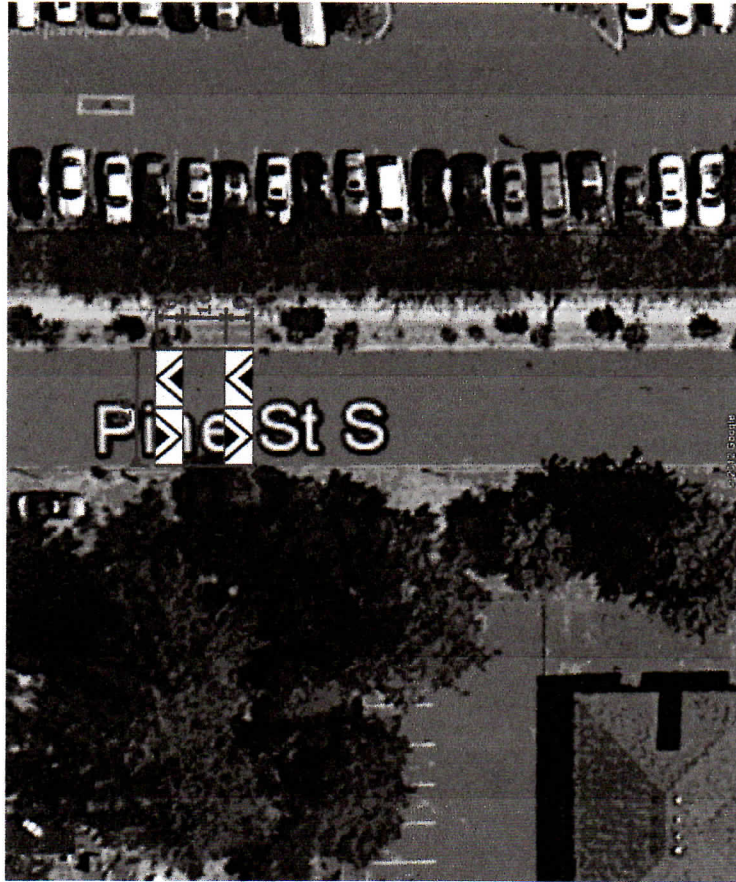

VARIES WITH WIDTH OF ROADWAY

SPEED TABLE - PLAN

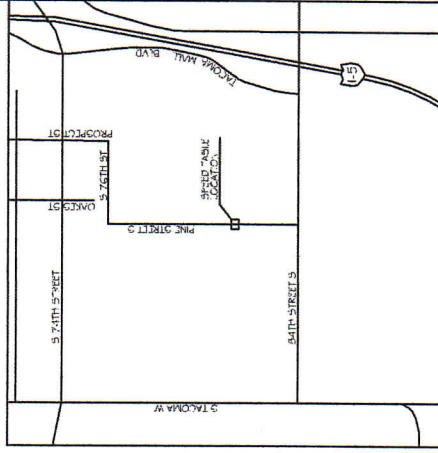

GENERAL NOTES:

- 1 MATERIALS AND CONSTRUCTION REQUIREMENTS SHALL BE IN ACCORDANCE WITH STANDARD SPECIFICATIONS FOR ROAD, BRIDGE, AND MUNICIPAL CONSTRUCTION UNLESS OTHERWISE NOTED.
- 2 EXACT LOCATIONS OF SPEED TABLES TO BE PROVIDED IN THE FIELD BY THE PROJECT ENGINEER.
- 3 TAPER SPEED TABLE TO TWO INCHES ABOVE EXISTING SHOULDER GRADE IF THERE IS NO CURB AND GUTTER.
- 4 TYPICAL SECTION "A-A" DEPICTS A NORMAL CROWN SECTION. EXISTING ROADWAY PAYMENT PROFILES SHALL BE OBTAINED FROM THE LOCAL PUBLIC WORKS DEPARTMENT. ALL SPEED TABLES SHALL BE CONSTRUCTED WITH 2" GRINDING AND HMA DEPTH AT THE MEET LINES.
- 5 SEE LANEWOOD STANDARD PLAN RW-13 FOR PAVEMENT MARKINGS AND SIGNAGE.

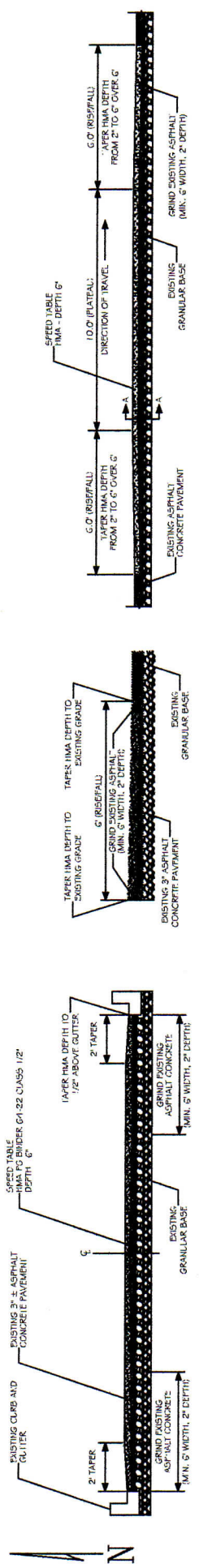

SPEED TABLE SECTION A-A

SPEED TABLE SECTION B-B

SPEED BUMP CENTER PROFILE

GENERAL NOTES:

- 1 MATERIALS AND CONSTRUCTION REQUIREMENTS SHALL BE PER LATEST EDITION OF WSDOT STANDARD SPECIFICATIONS FOR ROAD, BRIDGE, AND MUNICIPAL CONSTRUCTION UNLESS OTHERWISE NOTED.
- 2 EXACT LOCATIONS OF SPEED TABLES TO BE DETERMINED IN THE FIELD BY THE PROJECT ENGINEER.
- 3 IF THE CURB AND GUTTER DOES NOT EXIST, TAPER SPEED TABLE TO TWO INCHES ABOVE EXISTING SHOULDER GRADE.

GENERAL NOTES:

- 1 SIGNS AND PAINTED LOCATION SHALL BE VERIFIED BY THE ENGINEER PRIOR TO INSTALLATION.
- 2 SEE LAKWOOD STANDARD PLAN RW-11 AND RW-12 FOR SPEED TABLE CONSTRUCTION DETAILS.
- 3 SEE MUTCD FIGURE 3B-30 FOR PAVEMENT MARKING DETAILS.
- 4 TRAFFIC SIGNS SHALL HAVE BLACK BORDER AND REFLECTIVE SHEETING. SPEED SIGNS SHALL HAVE TYPE FOUR HIGH INTENSITY SHEETING.

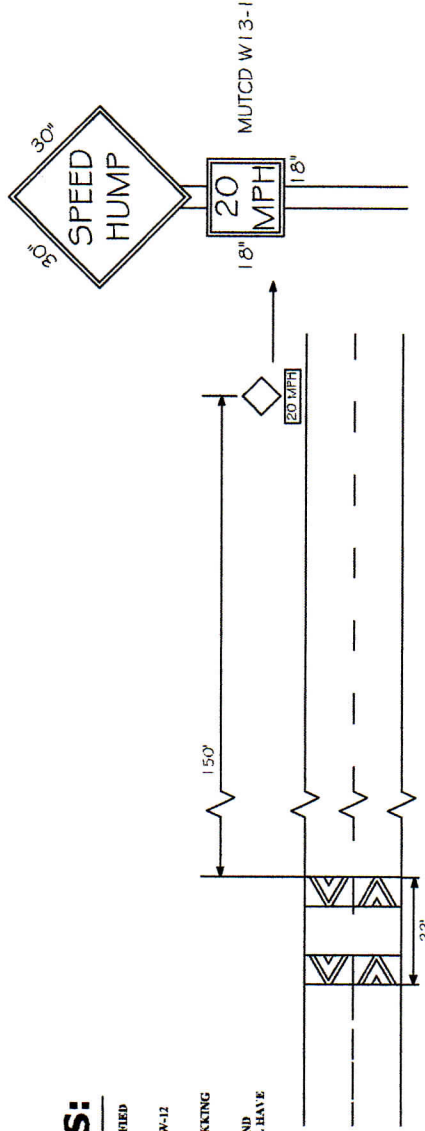
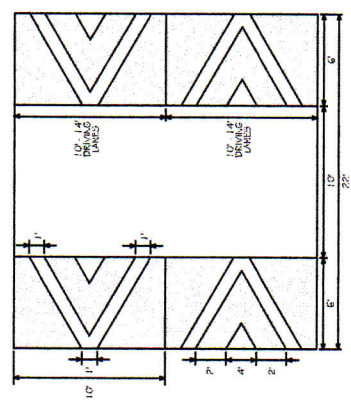



MENU

- ABOUT
- PRODUCTS & SOLUTIONS
- MUNICIPALITIES & ENGINEERS
- RESIDENTS
- TRAFFIC CALMING
- MEDIA
- RESOURCES

>Products and Solutions

Radar Speed Signs

- > [SafePace 100](#)
- > [SafePace 400](#)
- > [SafePace 500](#)
- > [SafePace 600](#)
- > [Radar Speed Sign Trailer](#)
- > [School Zone System](#)

Modular Rubber Solutions

- > [Speed Humps](#)
- > [Speed Tables](#)
- > [Speed Cushions](#)
- > [Traffic Circles](#)
- > [Curb Extensions/Medians](#)
- > [Alley Bumps](#)
- > [Cycle Lane](#)
- > [Mini Humps](#)
- > [Car Stops](#)

[Municipal Solutions](#) << [Speed Cushions](#)

Speed Cushions

Speed cushions are the newest available [traffic calming](#) device, and perhaps the most innovative. Speed Cushions have several distinct advantages. Designed as three small speed humps, speed cushions effectively slow cars down. However, the wider axle of emergency vehicles allows them to pass without slowing down. In addition, speed cushions are more affordable than speed humps or tables since they require less material.



- Main
- Features
- Dimensions**
- Technical Specs
- Installation Guide
- Photos

Dimensions

6'x7' Speed Cushion

Dimensions: 3" x 6' x 7'

This dimension is for one speed cushion, however cushions are generally installed across the road in a series as illustrated below of either two or three speed cushions depending on street width.

Product Warranty

Conditional Use Terms

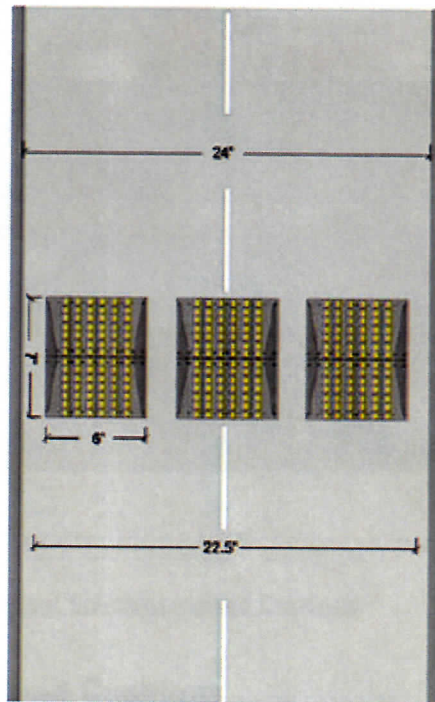

While standard product sizes are shown, the interlocking devices are fully customizable to any length or road width.

Traffic Logix solutions have been installed in hundreds of locations across North America.